

A2

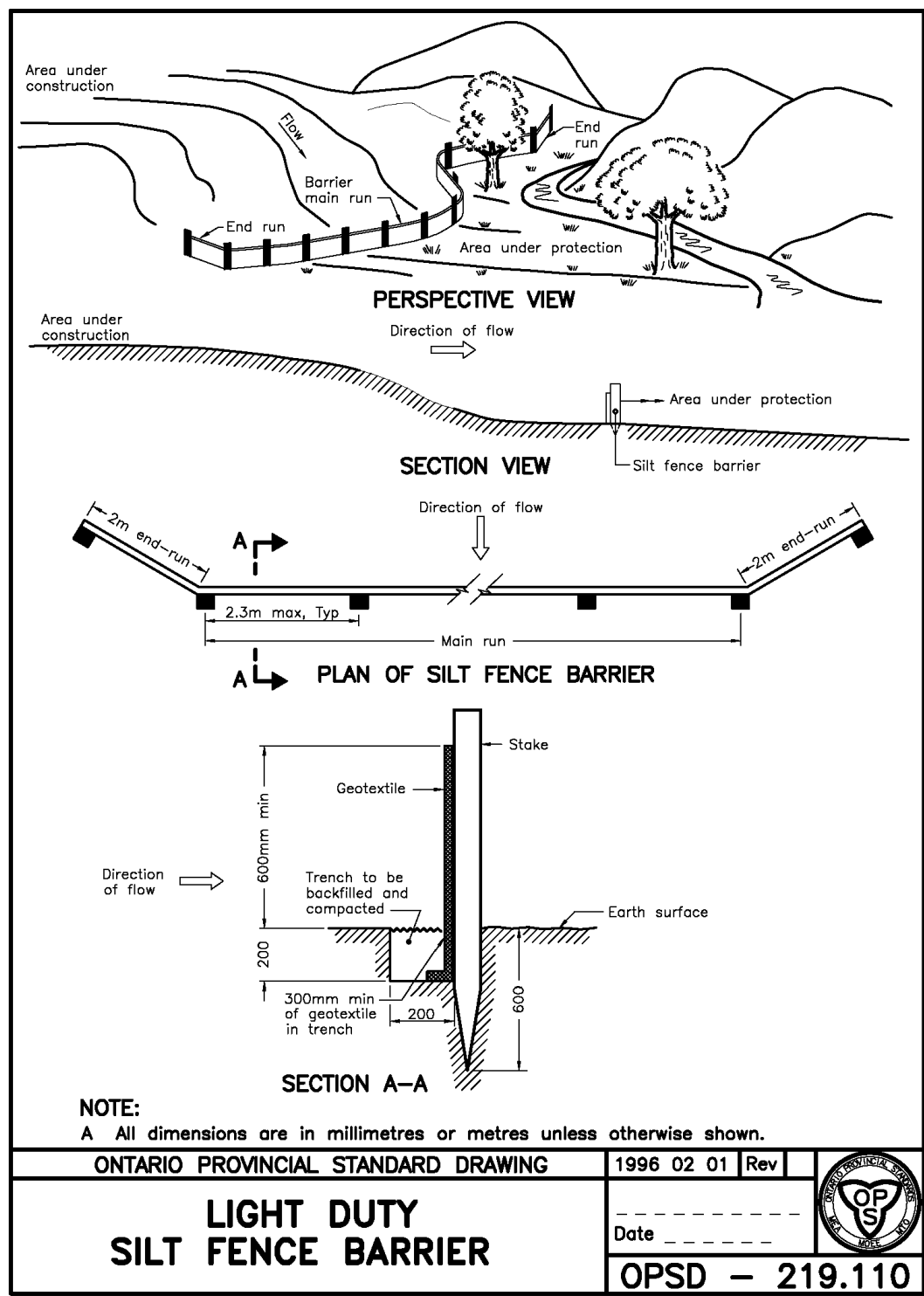
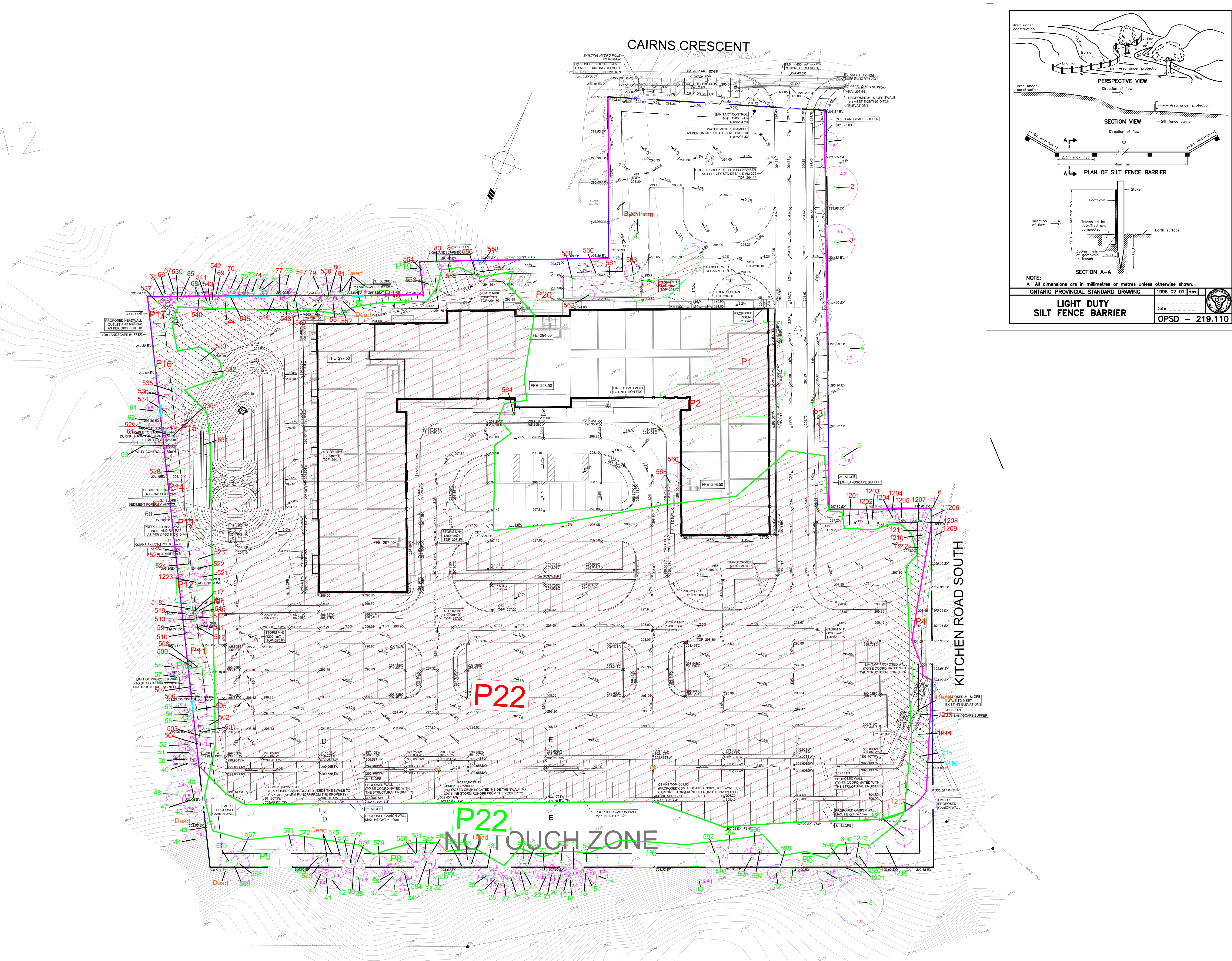

LEGEND

Tree Inventory

Refer to Appendix A and B of report dated 11 May 2023, revised 23 January 2024 and 4 August 2025 for the 100% tally of trees within P22 and the individual tree inventory outside of P22. All deciduous trees greater than or equal to 6 cm DBH and all coniferous trees greater than 2m in height were included in the 100% tally and the individual tree inventory.

Tree Removals

The removal of approximately 1,471 trees within P22 is required to accommodate the proposed development. The removal of an additional 103 individual trees and 14 polygons outside of P22 is also required as indicated with RED labels. The removal of 10 trees is recommended due to their condition. These trees are indicated with ORANGE labels.

Tree Preservation

Preservation of all other trees may be possible as indicated with GREEN labels. The minimum tree protection zone of trees are indicated in MAGENTA and required tree protection fencing is indicated in MAGENTA. Minimum tree protection zones were used for planning purposes to determine required tree removals. Refer to Tree Protection Plan Notes for preservation details and tree preservation fencing detail.

Tree location (located via GPS)

Tree polygon location

Section of polygon to be removed (RED Hatch)

Tree Label (RED) removal required

Tree Label (GREEN) preservation proposed

Tree Protection/ESC Fencing

Air-Spade Excavation

Minimum Tree Preservation Zone (MAGENTA Circle)

TREE PROTECTION PLAN NOTES

Prior to site disturbance the owner must confirm that no migratory birds are making use of the site for nesting. The owner must ensure that the works are in conformance with the Migratory Bird Convention Act and that no migratory bird nests will be impacted by the proposed work. It is the applicants' responsibility to discuss potential tree injury of trees on shared property lines with their neighbours. Should such trees be injured to the point of instability or death the applicant may be held responsible for removal and such issues would be dealt with in civil court or through negotiation.

TREE PROTECTION ZONE: No construction activity including grade changes, surface treatments or excavations of any kind is permitted within the area identified on the Tree Protection Plan or Site Plan as a Tree Protection Zone (TPZ). No root cutting is permitted. No storage of materials or fill is permitted within the TPZ. No movement or storage of vehicles or equipment is permitted within the TPZ. Grade changes are not permitted within established TPZ. The area(s) identified as a TPZ must remain undisturbed at all times.

For trees on private property situated on or adjacent to construction sites: Tree protection barriers must be installed around trees to be protected using snow fencing approved by the Town of Huntsville. All supports and bracing to safely secure the barrier should be outside the TPZ. All such supports and bracing should minimize damage to roots outside the TPZ.

General Note: Tree protection barriers must be installed around trees to be protected using snow fencing approved by the Town of Huntsville. All supports and bracing to safely secure the barrier should be outside the TPZ. All such supports and bracing should minimize damage to roots outside the TPZ.

ARBORICULTURAL WORK: Any roots or branches which extend beyond the TPZ indicated on this plan which require pruning, must be pruned by a qualified Arborist or other tree professional as approved by the Town of Huntsville. All pruning of tree roots and branches must be in accordance with good arboricultural standards. Roots located outside the TPZ that have received approval from the Town of Huntsville to be pruned must first be exposed by hand digging or by using a low pressure hydro vac method. This will allow a proper pruning cut and minimize tearing of the roots. The Arborist/tree professional retained to carry out crown or root pruning must contact the Town of Huntsville prior to conducting any specified work.

No.	Issue/Revisions	Date	By
1	Report and Figure Submission	11 May '23	IB
2	Report and Figure Revision	23 Jan '24	IB
3	Report and Figure Revision	4 Aug '25	IB
4			

Base Data: Maughan Surveyors (Topo)



Client
1000120857 Ontario Inc.
110 Matheson Boulevard West, Suite 120
Mississauga, ON L5R 4G7

Property
20 Cairns Crescent
Huntsville, Ontario

Forest/Tree Inventory and Preservation Plan

Project	P3676	Figure	1
Date	11 May 2023		
Scale	1:350		