



NOTE:
 -EXISTING VEGETATION SHALL BE MAINTAINED IN A NATURALLY VEGETATED STATE.
 -ALL EXTERIOR LIGHTING SHALL BE DARK SKY COMPLIANT IN ACCORDANCE WITH TOWN OF HUNTSVILLE OUTDOOR LIGHTING BY-LAW, AS AMENDED FROM TIME TO TIME.

- A - EXISTING RESIDENCE 26' X 37' 89.4 SQM
- B - EXISTING GARAGE 28' X 32' 83.3 SQM
- C - EXISTING DECK 16' X 10' 14.9 SQM
- D - SECONDARY RESIDENTIAL DWELLING 26' X 28' 67.6 SQM
- E - EXISTING TILE BED
- F - PROPOSED TILE BED
- G - EXISTING SEPTIC TANK
- H - PROPOSED SEPTIC TANK
- I - PROPOSED 3 SEASON ROOM 24' X 16' 35.7 SQM

LOT AREA 2.03 ACRES 8215.12SQM
 EXISTING LOT COVERAGE 2.3%
 PROPOSED LOT COVERAGE 3.54%

NOTES:

- DO NOT SCALE DRAWINGS.
- CONTRACTOR/BUILDER TO VERIFY ALL DIMENSIONS.
- ALL MANUFACTURED MATERIALS TO BE HANDED AND STORED AS PER MANUFACTURES INSTRUCTIONS.
- CONTRACTOR/BUILDER IS RESPONSIBLE FOR ARRANGING ALL INSPECTIONS AS PER O.B.C.
- ALL HEALTH AND SAFETY REGULATIONS TO BE FOLLOWED WITH REGARDS TO CONSTRUCTION OF THIS PROJECT.
- THE DESIGNER SHALL BE NOTIFIED OF ANY CHANGES IN SITE CONDITIONS WHICH MAY REQUIRE CHANGES IN EXISTING DESIGN ASSUMPTIONS.

May 07/26	Added fence heights and material.
Apr. 29/26	3 season room and fence added.
Mar. 23/26	Site plan information added.
Feb. 01/26	Site plan information added.
Jan.29/26	Site plan information added.
Dec. 06/25	Added lintel sizes & plumbing diagram. Altered site plan.
Nov. 17/25	Released for permit submittal.
Nov. 08/25	Initial draft for review.
Date	Revision

DOUBLE D DRAFTING & DESIGN
 4277 STISTED ROAD S.
 SPRUCEDALE, ONTARIO POA 1Y0

Email: doubledraftinganddesign@gmail.com

I review and take responsibility for the design work on behalf of a firm registered under subsection 3.2.4 of Division C, of the Building Code. I am qualified, and the firm is registered, in the appropriate classes/categories.

Signed: *[Signature]*

705-788-4553
 B.C.I.N. 38724
 FIRM B.C.I.N. 102590

Project Name and Address

Stevee Ancil
 175 N. Waseosa Lake Rd.
 Huntsville, Ontario
 P1H 2J4

Project
 3 Season Room and Fence **A105**

Date
 April 29 2026 Sheet

Scale
 1" = 20'-0" Site Plan

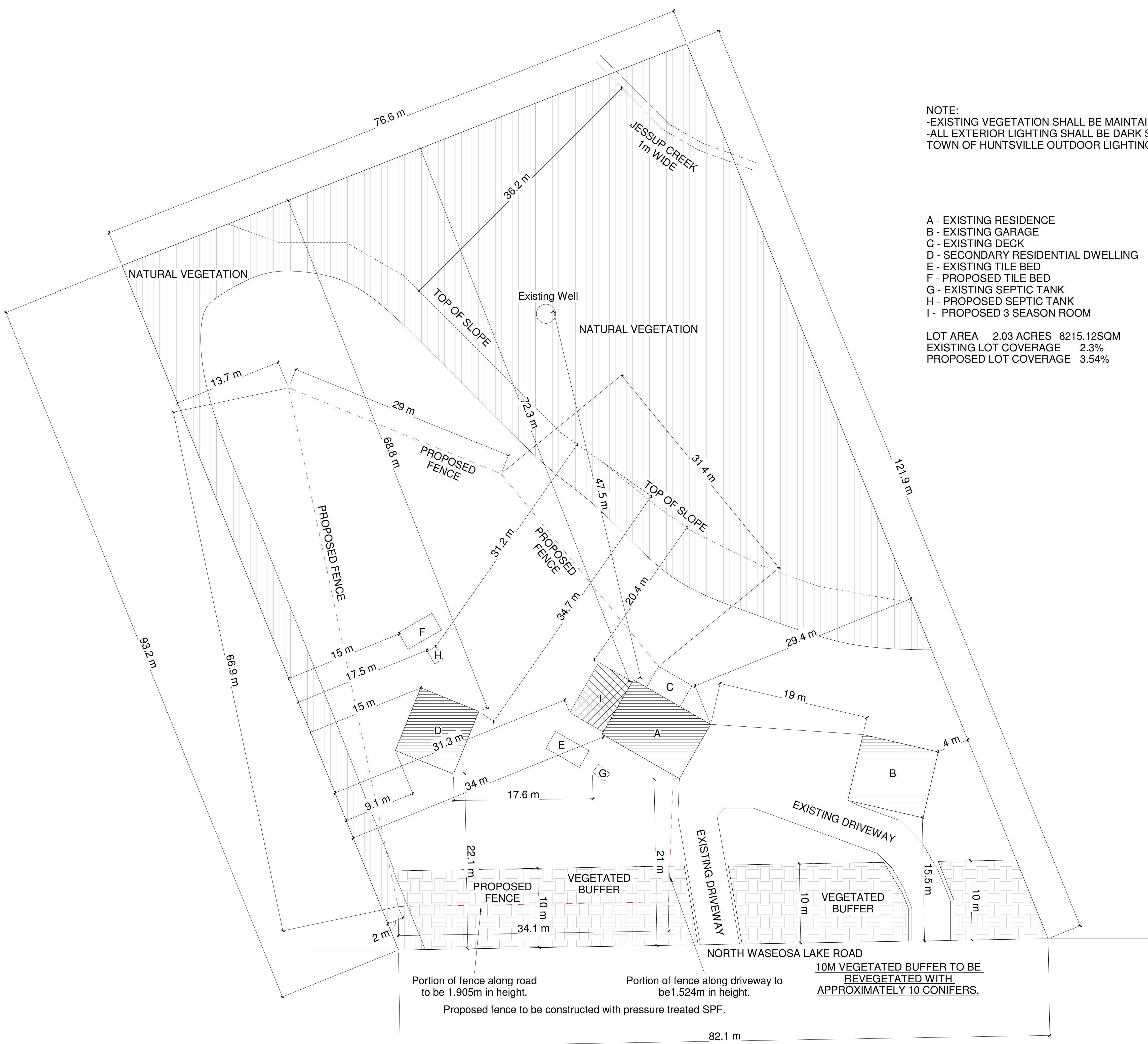

Portion of fence along road to be 1.905m in height.
 Proposed fence to be constructed with pressure treated SPF.

Portion of fence along driveway to be 1.524m in height.

10M VEGETATED BUFFER TO BE REVEGETATED WITH APPROXIMATELY 10 CONIFERS.

SITE PLAN FOR 175 NORTH WASEOSA LAKE ROAD
 CON 11 PT LOT 17 RP 35R18965 PART 1