

SITE PLAN OF
PART OF LOTS 20 & 21, CONCESSION I I
GEOGRAPHIC TOWNSHIP OF BRUNEL
TOWN OF HUNTSVILLE
DISTRICT MUNICIPALITY OF MUSKOKA

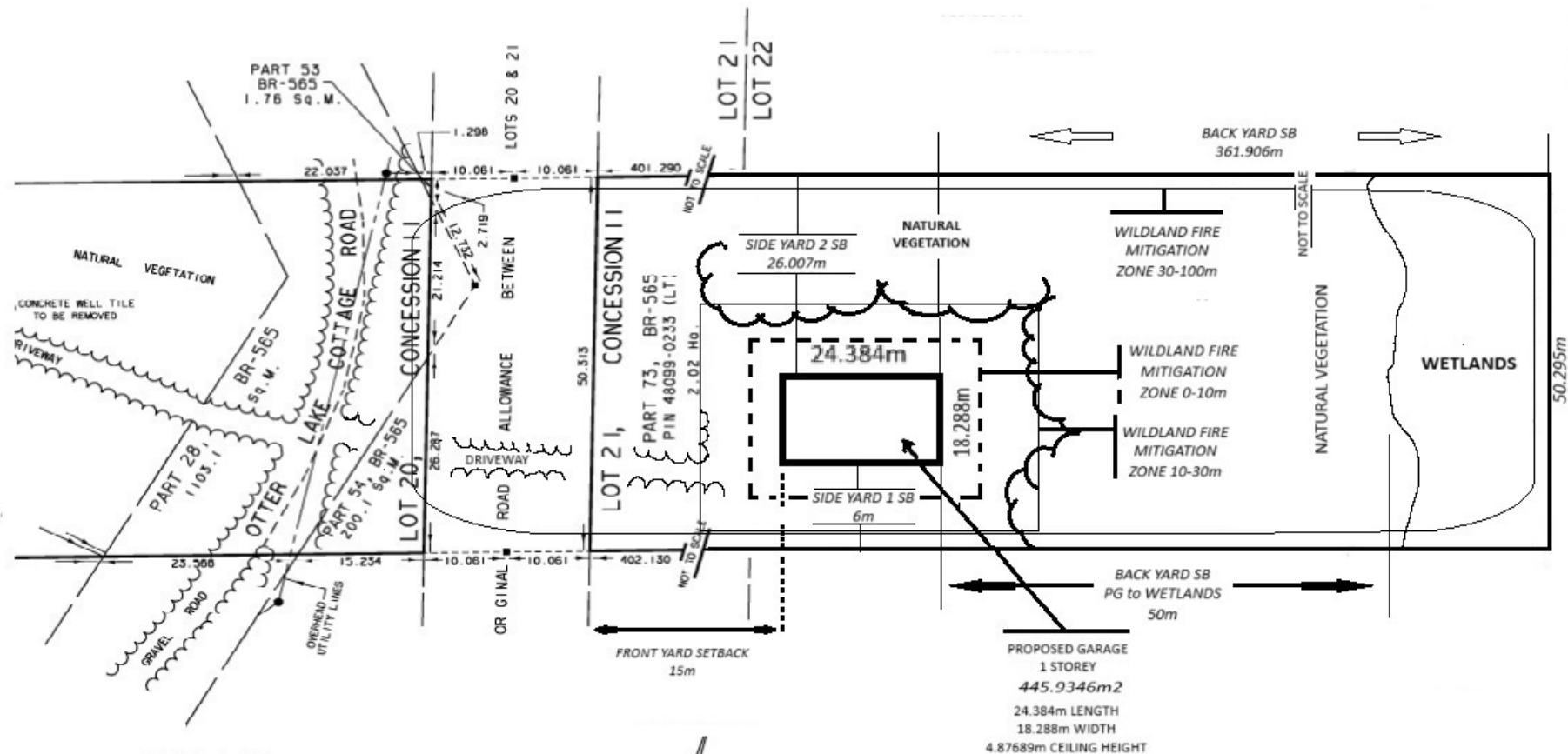

NOTE:
ALL VEGETATION BETWEEN THE DWELLING
AND THE HIGH WATER MARK SHALL REMAIN
IN ITS NATURAL STATE, EXCEPT AS
QUALIFIED HEREIN.

⇒ DENOTES DIRECTION OF FLOW



OWNER
C.D. MCRAE
186 OTTER LAKE COTTAGE ROAD
HUNTSVILLE, ON.

October 1, 2024

Chris McRae
2 Treanor Crescent, Georgetown
Ontario, L7G 5J1

Phone: (416) 984-8804
Drawn by: C.M. File: D185JEP Plan: 60X80X16

WILDLAND FIRE MITIGATION:

Zone 0-10m around building envelope. In the area of the property between 0 to 10 m (ZONE 1) from the proposed structure, the following wildland fire mitigation measures are to be implemented: -Prune shrubs and trees; -Remove deadfall; -Relocate any woodpiles outside priority zone 1 (area within 10 m of structure); -Mow and water grass in the dry season; -Prune conifer branches to remove any that overhang roofs or that are within 2 metres of the ground; -Replace conifer trees and shrubs with native deciduous/hardwood species; and -Use non-combustible landscaping products.

Zone 10-30m around building envelope. In the area of the property between 10 – 30 m from the proposed structure, the following wildland fire mitigation measures are to be implemented: -Thin trees and remove downed woody debris; -Space the crowns of conifer trees at least 3-6m apart to reduce crown fire spread; -Plant native hardwood species when replanting trees in this zone (10-30 m from structure); -Remove dead woody debris, thick shrubbery and lower branches of mature trees that may provide the opportunity for ground fire to climb into the canopy (i.e. ladder fuels); and -Remove selective trees rather than blocks of trees (space 3-6 m).

Zone 30-100m around building envelope. In the area of the property between 30-100 m from the proposed structure, the following wildland fire mitigation measures are to be implemented: -Thin and reduce shrubs and trees that make up the understory, while retaining fire-resistant deciduous trees; -Space conifer trees such that crowns are at least 3-6m apart to reduce the potential for a crown fire; and -Removed downed wood accumulating on the forest floor and dead standing conifers.